

OWL V-LATCH SURFACE HEAD ASSEMBLY | PWL - PWL3

ASSY.	DESCRIPTION	PART NUMBER	WEIGHT	
			<i>lb</i>	<i>kg</i>
A	Head assy PWL/3 OWL	10S-P10-005VL	48.06	21.80
B	Inner tube cap assy PWL/3 OWL	10S-P10-031SL *	5.51	2.50



	DESCRIPTION	PART NUMBER	
A	Spearhead point	10S-10-006	
	Compression spring	10S-10-009	
	Detent plunger	10S-10-010	
	Spiral pin 7/16" X 1"	10S-10-008	
	Spearhead base	10S-H10-011	
	Coiled spring pin 1/2" X 2-3/4" (2)	10S-H10-080SL *	
	Latch retracting case	10S-P10-013SL *	
	Piston compression spring	10S-P10-014SL *	
	Piston	10S-P10-070VL *	
	Spring locking pin	10S-P10-087SL *	
	Slotted spring pin 1/2" X 2"	10S-10-012	
	Latch (2)	10S-P10-015VL *	
	Upper latch body	10S-P10-19USL *	
	Landing shoulder	10S-P10-19S	
	Landing indicator bushing	10S-10-016	
	Stainless steel ball 22mm	10S-10-052	
	Lower latch body	10S-P10-19L	
	Wedge lock washers (1 set of 2)	10S-P10-085	
	Hex nut	10S-P10-020	
	Stop valve spindle	10S-P10-083 *	
	Shut-off valve hard (2)	10S-P10-22HSL *	
	Valve adjusting washer (2)	10S-P10-023SL *	
	Taper washer	10S-P10-084 *	
	Ball thrust bearing (3)	10S-H10-025	
	Spindle bearing	10S-P10-026SL *	
	Grease fitting 1/4" - 28 straight	10S-10-31G	
	Spindle shaft	10S-P10-082 *	
	Compression spring - New style LW	10S-P10-028	
	Narrow washer 1-1/4" - New style LW	10S-P10-029	
	Lock nut nylon	10S-P10-030SL *	
	Spindle housing	10S-P10-081 *	
	Spindle flanged bearing	10S-P10-080 *	
	B	Stainless steel ball 22mm	10S-10-052
Inner tube cap		10S-P10-31B *	
Spring pin 3/16" X 2-1/4"		10S-P10-086	

* Must be original Fordia parts in order to ensure proper functioning of the coring system.

OWL V-LATCH SURFACE | PWL - PWL3 PARTS

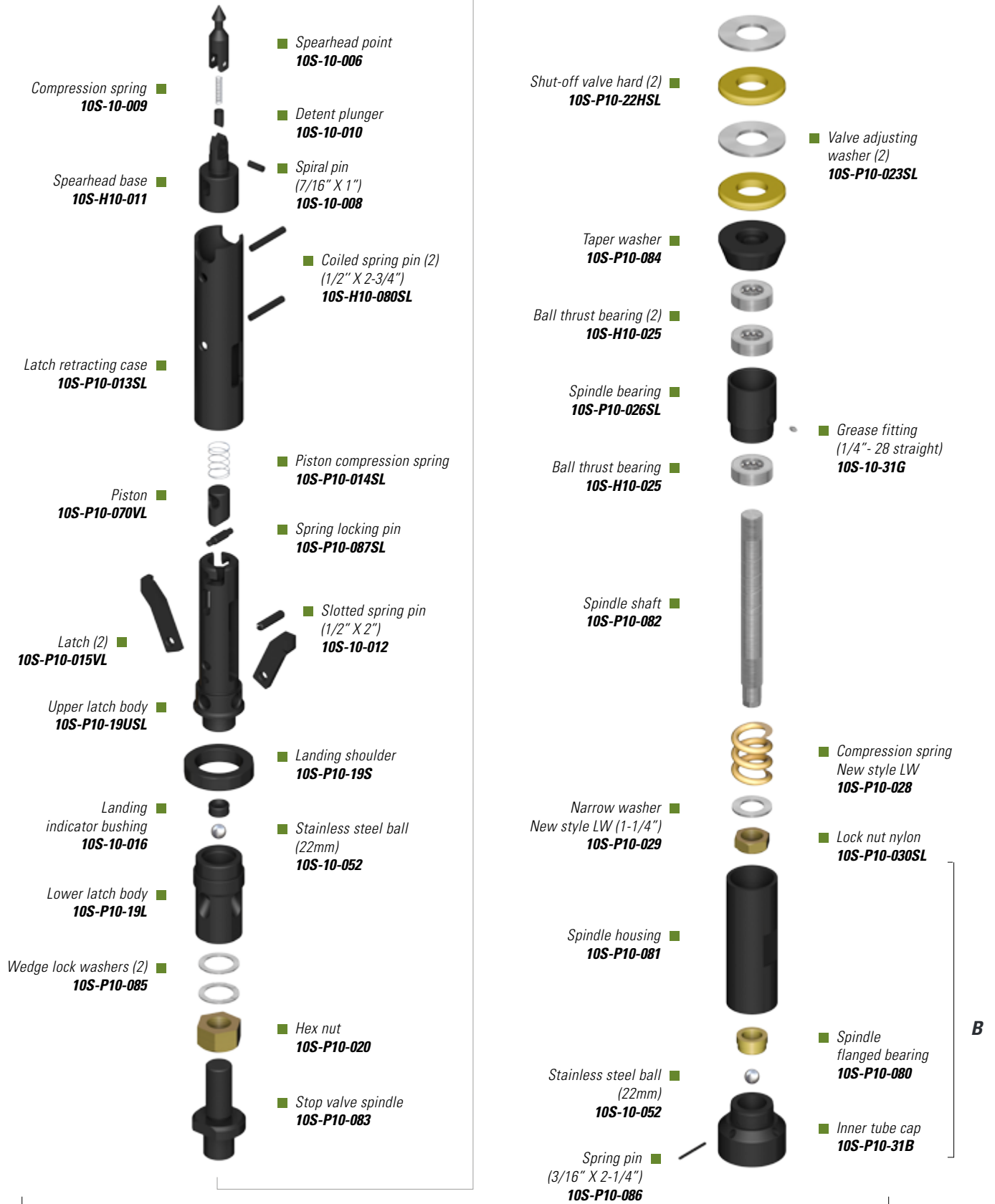

A

B