

OWL V-LATCH SURFACE HEAD ASSEMBLY | **BWL - BWL3**

ASSY.	DESCRIPTION	PART NUMBER	WEIGHT	
			lb	kg
A	Head assy BWL/3 OWL V-L	10S-B10-005VL	12.56	5.70
B	Inner tube cap assy BWL/3/U OWL	10S-B10-031	1.94	0.88



	DESCRIPTION	PART NUMBER	
A	Spearhead point	10S-10-006	
	Compression spring	10S-10-009	
	Detent plunger	10S-10-010	
	Spiral pin 7/16" X 1"	10S-10-008	
	Spearhead base	10S-B10-011	
	Coiled spring pin 3/8" X 1-5/8" (2)	10S-B10-012SL	
	Latch retracting case	10S-B10-013SL	
	Spring lock nut	10S-B10-071SL	
	Piston compression spring	10S-B10-014SL	
	Piston	10S-B10-070VL	
	Latch (2)	10S-B10-015VL	
	Spring pin 3/8" X 1-1/4"	10S-B10-017	
	Upper latch body	10S-B10-19USL	
	Landing shoulder	10S-B10-19S	
	Landing indicator bushing	10S-10-016	
	Stainless steel ball 22mm	10S-10-052	
	Lower latch body	10S-B10-19L	
	Hex nut	10S-B10-020	
	Spindle shaft	10S-B10-021	
	1 Shut-off valve hard (2)	10S-B10-22H	
	Valve adjusting washer (2)	10S-B10-023	
	Ball thrust bearing (2)	10S-B10-025	
	Spindle bearing	10S-B10-026	
	Compression spring	10S-B10-028	
	Lock nut	10S-B10-030	
	B	Inner tube cap	10S-B10-31B
		Grease fitting 1/4"- 28 straight	10S-10-31G
		Stainless steel ball 3/4"	10S-B10-31S
		Check valve body	10S-B10-31C

1 Optional shut-off valves (soft) are also available. Please use the following part number 10S-B10-22S to place an order.

OWL V-LATCH SURFACE | BWL - BWL3 PARTS

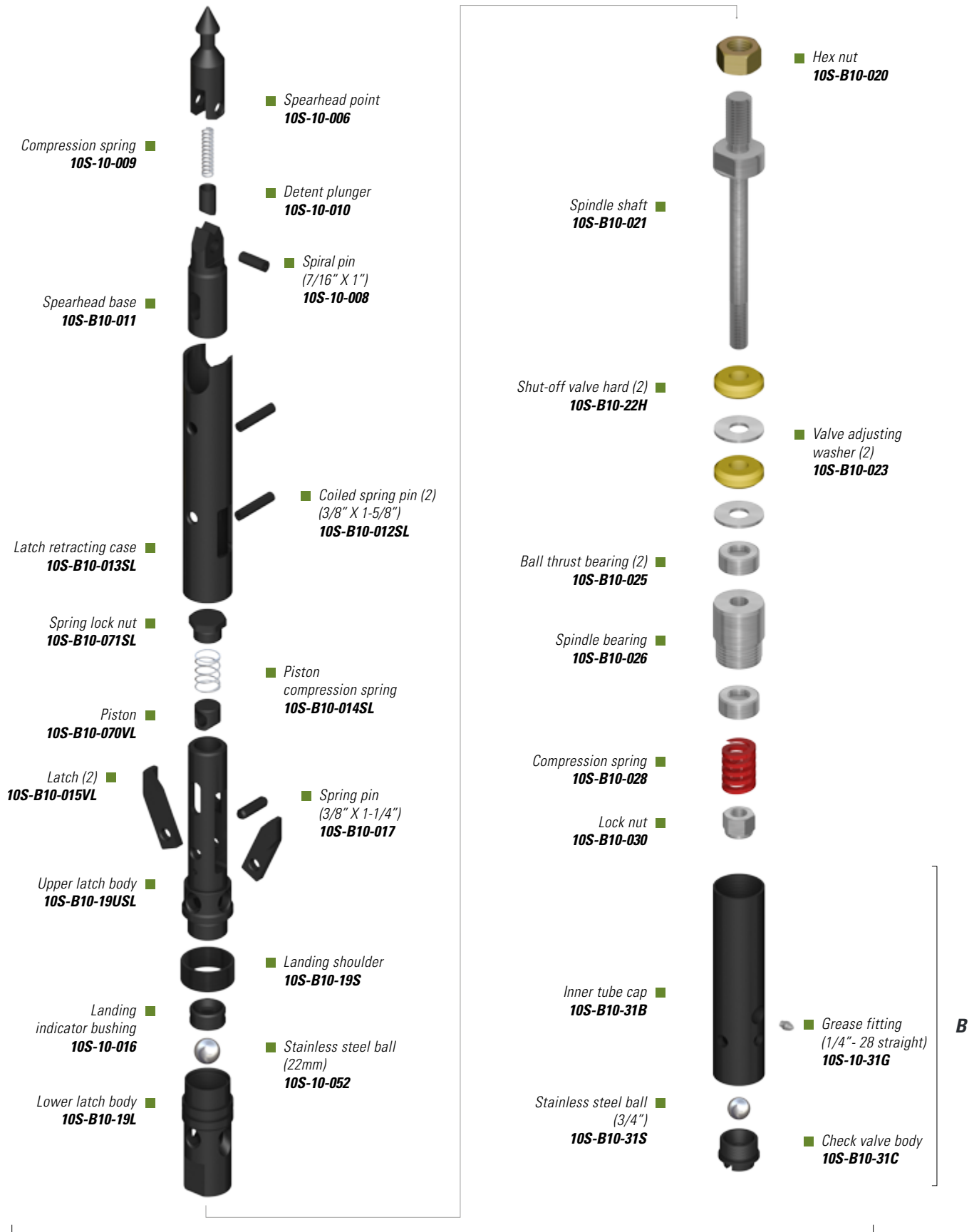

A

B