

OWL V-LATCH SURFACE HEAD ASSEMBLY | **NWL - NWL3**

| ASSY. | DESCRIPTION | PART NUMBER | WEIGHT | |
|-------|---------------------------------|---------------|--------|-------|
| | | | lb | kg |
| A | Head assy NWL/3 OWL V-L | 10S-N10-005VL | 22.04 | 10.00 |
| B | Inner tube cap assy NWL/3/U OWL | 10S-N10-031 | 3.08 | 1.40 |



| | DESCRIPTION | PART NUMBER | |
|---|----------------------------------|----------------------------------|-------------|
| A | Spearhead point | 10S-10-006 | |
| | Compression spring | 10S-10-009 | |
| | Detent plunger | 10S-10-010 | |
| | Spiral pin 7/16" X 1" | 10S-10-008 | |
| | Spearhead base | 10S-N10-011 | |
| | Coiled spring pin 1/2" X 2" | 10S-N10-012SL | |
| | Coiled spring pin 3/8" X 2" | 10S-H10-018SL | |
| | Latch retracting case | 10S-N10-013SL | |
| | Spring lock nut | 10S-N10-071SL | |
| | Piston compression spring | 10S-N10-014SL | |
| | Piston | 10S-N10-070VL | |
| | Latch (2) | 10S-N10-015VL | |
| | Slotted spring pin 1/2" X 1-1/2" | 10S-10-017 | |
| | Upper latch body | 10S-N10-19USL | |
| | Landing shoulder | 10S-N10-19S | |
| | Landing indicator bushing | 10S-10-016 | |
| | Stainless steel ball 22mm | 10S-10-052 | |
| | Lower latch body | 10S-N10-19L | |
| | Hex nut | 10S-N10-020 | |
| | Spindle shaft | 10S-N10-021 | |
| | 1 Shut-off valve hard (2) | 10S-N10-22H | |
| | Valve adjusting washer (2) | 10S-N10-023 | |
| | Ball thrust bearing | 10S-N10-025 | |
| | Spindle bearing | 10S-N10-026 | |
| | Hanger bearing | 10S-N10-027 | |
| | Compression spring | 10S-N10-028 | |
| | Lock nut | 10S-N10-030 | |
| | B | Inner tube cap | 10S-N10-31B |
| | | Grease fitting 1/4"- 28 straight | 10S-10-31G |
| | | Stainless steel ball 22mm | 10S-10-052 |
| | | Check valve body | 10S-10-31C |

1 Optional shut-off valves (soft) are also available. Please use the following part number 10S-N10-22S to place an order.

OWL V-LATCH SURFACE | NWL - NWL3 PARTS

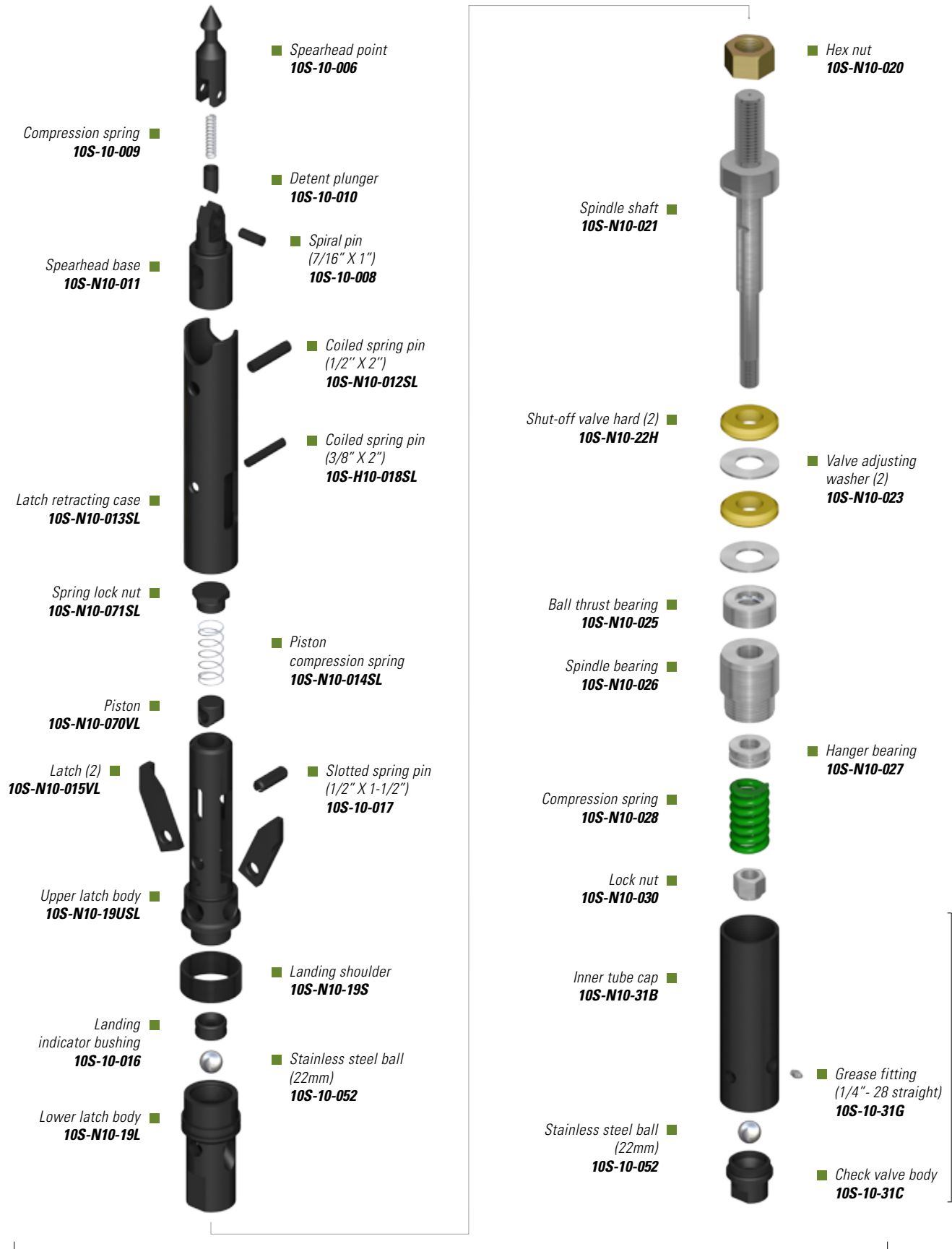

A

B